

# Venue Hire Information

---



## Venue Spaces

---

Our club has two spaces available for hire.

### **Main Function Area – 153 m<sup>2</sup>**

This premium space includes access to the main balcony along the building's frontage, providing uninterrupted views of New Brighton's beach and Pier, and out into the Pacific Ocean. Access is also included to the landscape deck at the rear of the building. This space also comes equipped with a kitchen, bar, lift for disability access, high-speed Wi-Fi and an AV system with multiple TV screens.

### **Member Lounge – 77 m<sup>2</sup>**

The Members lounge is a smaller space perfect for community groups or businesses to hold meetings or other business activity. This area comes with tables and chairs, kitchen facilities and high-speed Wi-Fi.



**Contact:**  
[info@newbrightonslsc.org.nz](mailto:info@newbrightonslsc.org.nz)

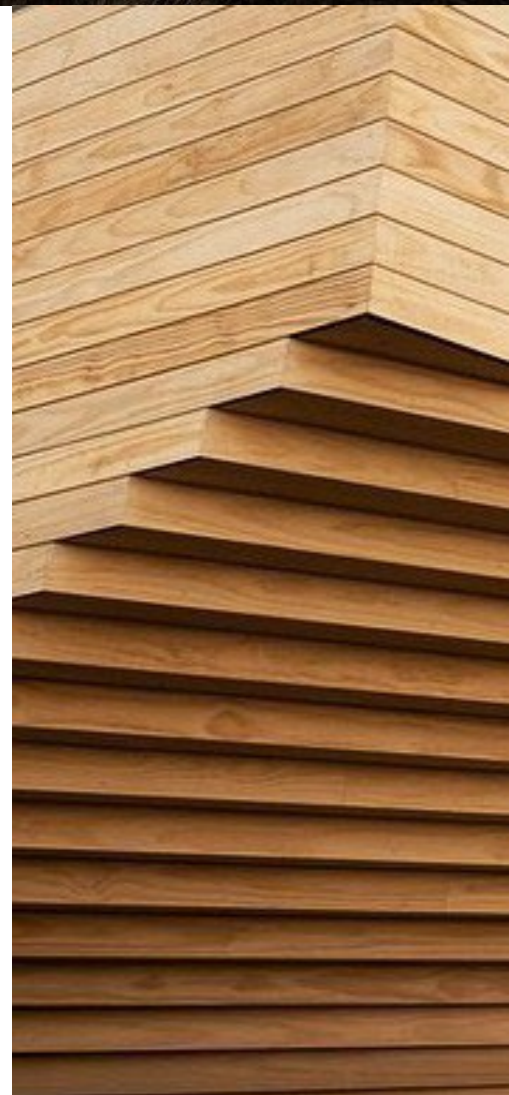

# Venue Hire Charges

Area	Time	Price	Facilities
<b>Main function area</b> (153 mm <sup>2</sup> )	<b>Daytime events</b> Monday – Friday 8:30am – 5pm	\$150.00 per hour	<ul style="list-style-type: none"> <li>• Back deck</li> <li>• Front balcony</li> <li>• Main bar</li> <li>• Commercial kitchen</li> <li>• Lift</li> <li>• AV system</li> <li>• Multiple TV screens</li> <li>• Tables and chairs</li> <li>• High speed Wi-Fi</li> </ul>
	<b>Night time events*</b>	\$1500	
	<b>Weddings*</b>	\$2700	
<b>Member lounge</b> (Size 77 mm <sup>2</sup> )	<b>Daytime events</b> Monday – Friday 8:30am – 5pm (outside of patrol)	\$30–50 per hour (lower rate for community groups)	<ul style="list-style-type: none"> <li>• Meeting table</li> <li>• Chairs</li> <li>• Lifeguard kitchen</li> <li>• High speed WiFi</li> </ul>
	Space not available for night time events	Space not available for night time events	

NOTE: All prices are in New Zealand Dollars, and inclusive of GST. Our venue is not available for 18<sup>th</sup> or 21<sup>st</sup> occasions, and lifeguards are present 11-5pm on weekends from mid November to early March.

\*For wedding and evening bookings a \$300 bond is required. Early access is available from 9 am for setting up. The deck area must be vacated by 11 pm, and whole venue vacated by all guests by 12 am. The hirer must ensure that all belongings are collected and the venue is clean by no later than 9 am the following morning.

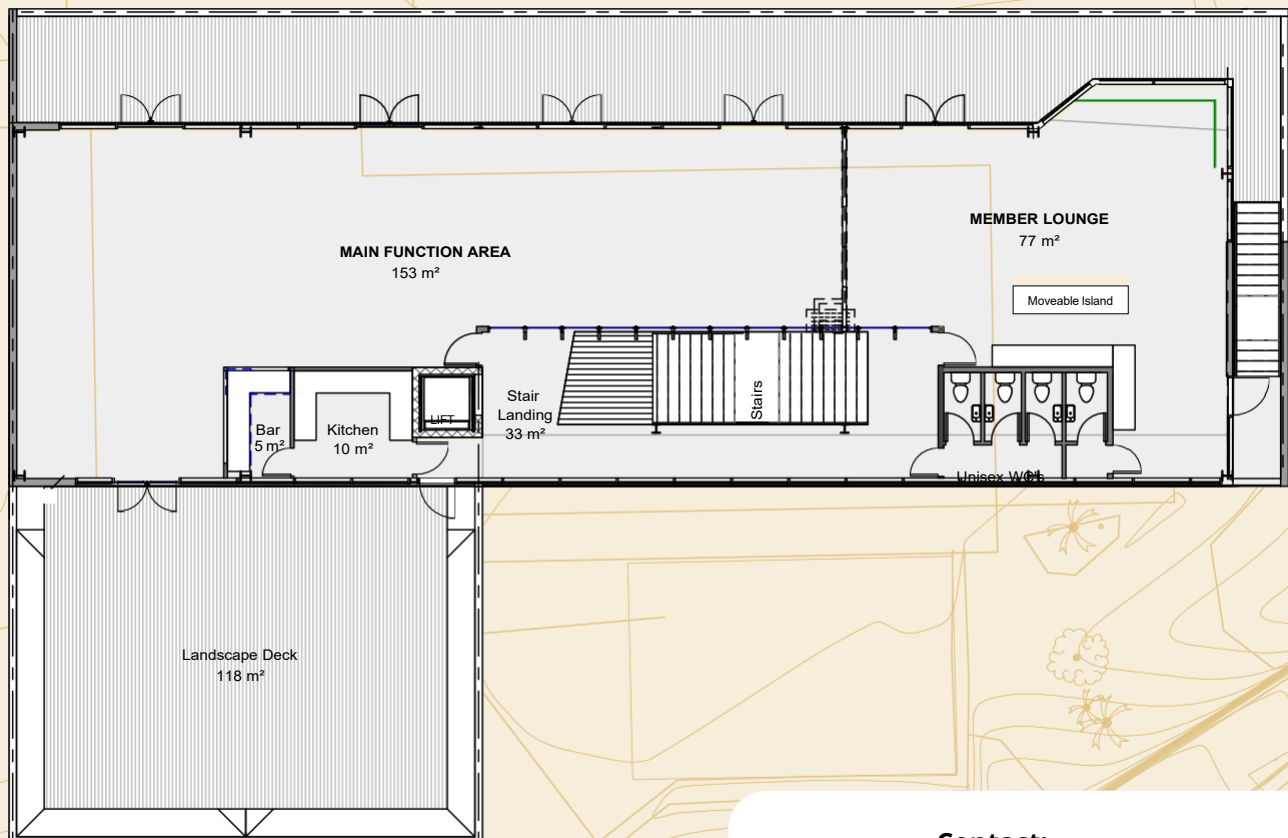

**Contact:**

info@newbrightonslsc.org.nz